



2024 SIDEWALK TENDER FORM

Claresholm

Company Name: _____

Company Representative: _____ SIGNED: _____

Required work to bid on:

Approximately - 500+m of sidewalk removal and replacement in various locations in town. Various lengths and types of products to be replaced. Please provide a price for each below.

**100mm compacted base gravel to be installed by contractor on all sidewalk replacement.
110mm minimum sidewalk thickness.**

Removal & Placement	Measurement	Price (\$)
T5 – Vertical Face Curb & Gutter	Lineal meter	_____
T6 – Low Profile Rolled Curb & Gutter	Lineal meter	_____
T7 – Vertical Face Monolithic Sidewalk	Lineal meter	_____
T8 – Low Profile Rolled Monolithic Sidewalk	Lineal meter	_____
T9 – Paraplegic Ramp	Per Ramp	_____
Standard Sidewalk (1.2 meter wide)	Lineal meter	_____
Concrete Swale (1 meter wide) (Rebar/Fiber) (Hi Early)	Lineal meter	_____

Dowling required to all to existing sidewalk.

Concrete to be 30mpa with fiber added.

All backfill and pavement restoration and cleanup are the contractor's responsibility.

A One (1) year warranty on all work completed is required.

BID DEADLINE: **May 3, 2024**

PROJECT COMPLETION: **September 27, 2024**

***TOWN TO SUPPLY TOPSOIL at our facility for contractors use. TOWN TO SUPPLY CONCRETE DUMP SITE of clean concrete only hauled by contractor to site 6km's.
CONTRACTOR TO DO ALL RECLAMATION & SEEDING.**

OFFICE USE ONLY

TENDER RECEIVED BY: _____

DATE: _____

TENDER REVIEWED BY: _____

DATE: _____

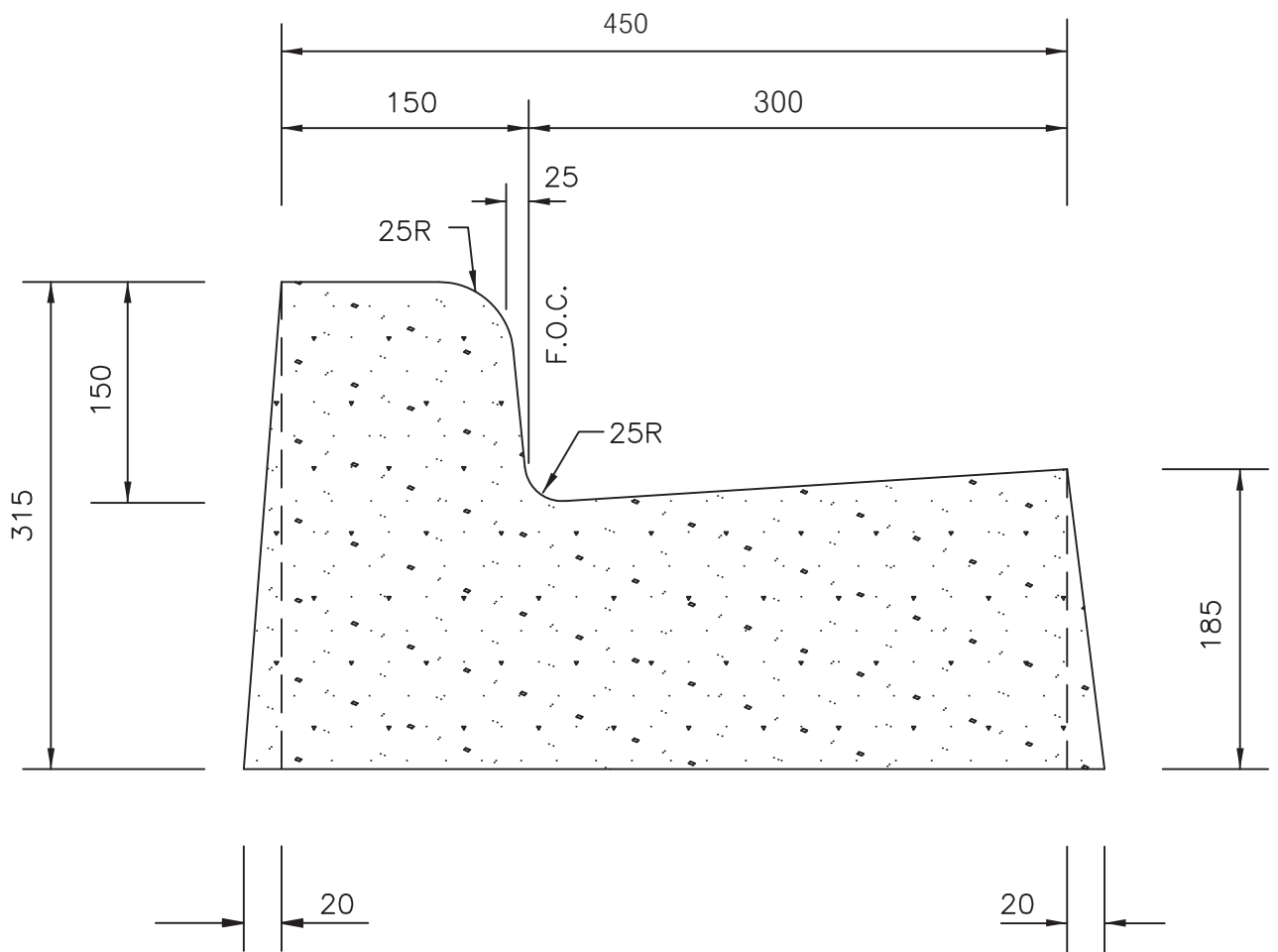

REVISIONS			Town of Claresholm	
Date	Details	Approved	VERTICAL FACE CURB & GUTTER	
			APPROVED: I.D.C.	STD. DWG. No.
			SCALE: NTS	T5
			DATE: September, 2007	

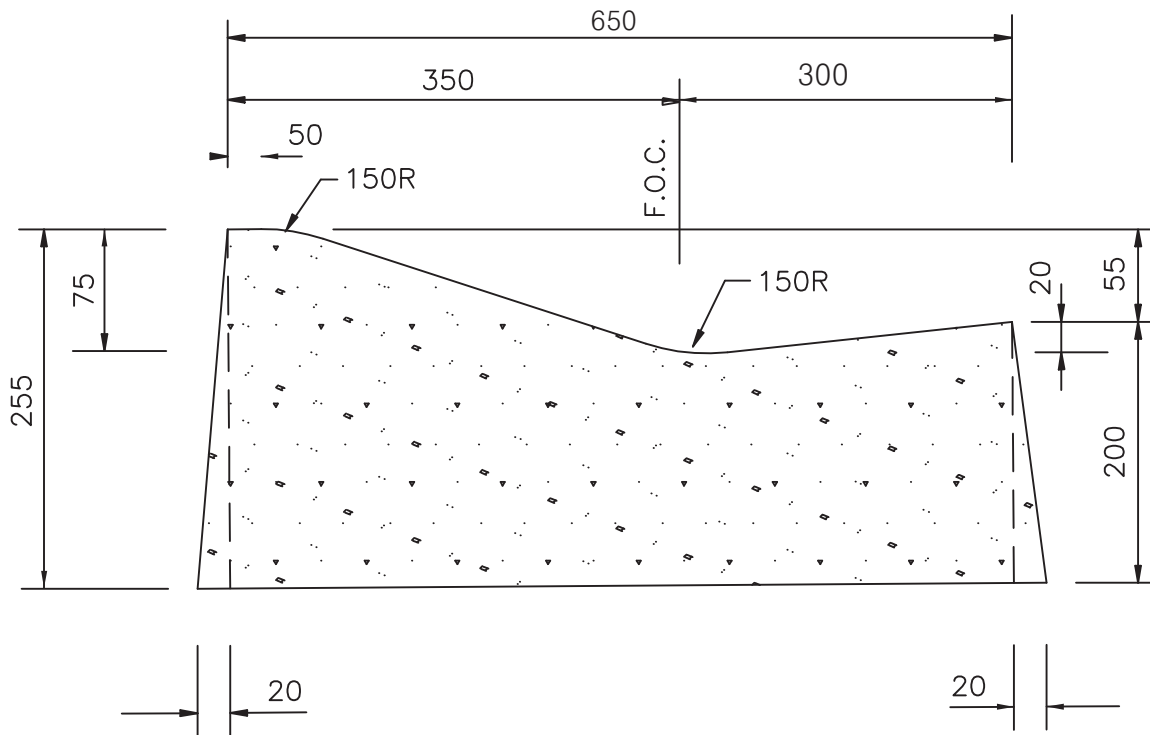

REVISIONS			Town of Claresholm LOW PROFILE ROLLED CURB AND GUTTER	
Date	Details	Approved		
			APPROVED: I.D.C.	STD. DWG. No.
			SCALE: N.T.S.	T6
			DATE: September, 2007	

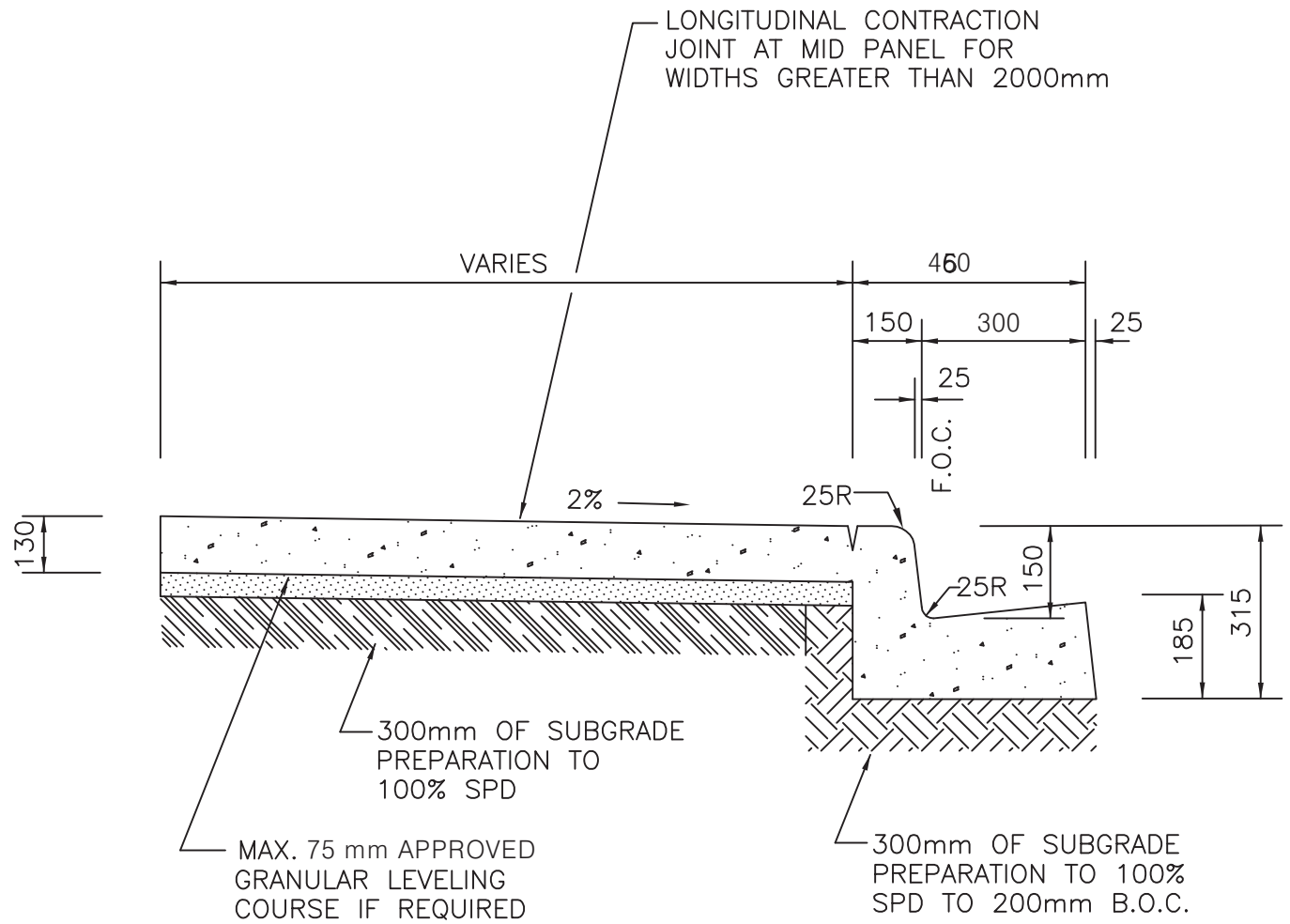

REVISIONS			Town of Claresholm	
Date	Details	Approved		
			APPROVED: I.D.C.	STD. DWG. No.
			SCALE: N.T.S.	T7
			DATE: September, 2007	

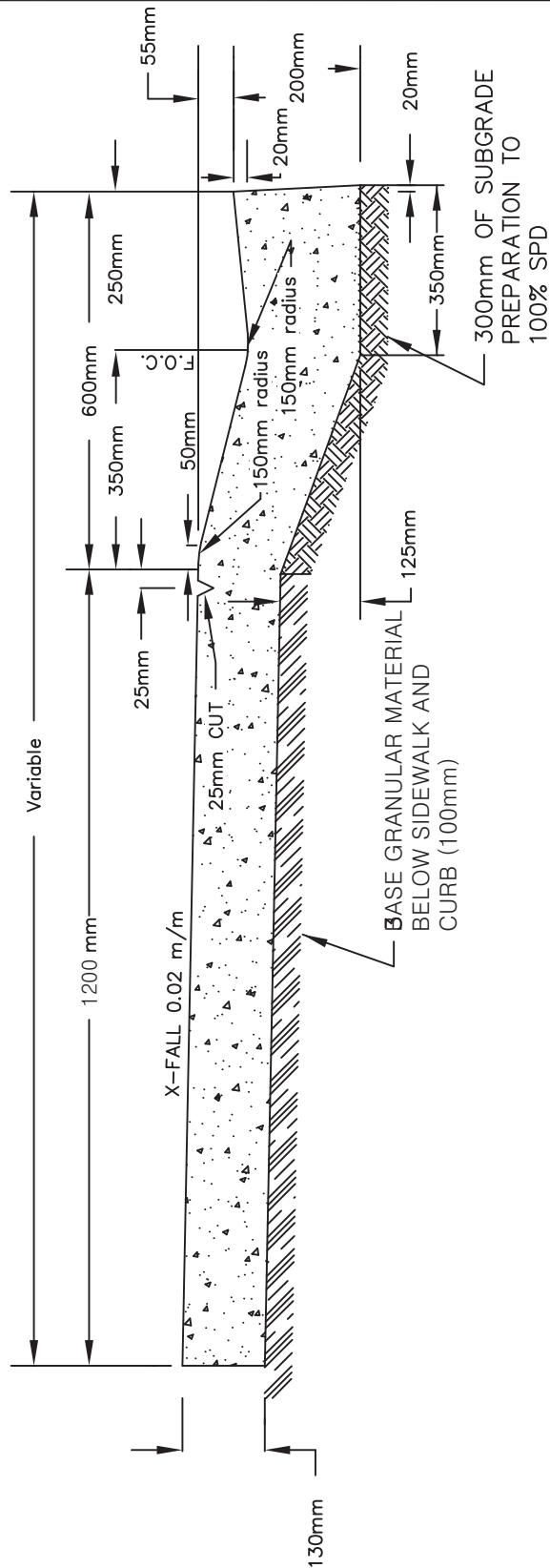

1.5m SIDEWALK MAY BE REQUIRED IN HIGH PEDESTRIAN TRAFFIC AREAS

REVISIONS			Town of Claresholm LOW PROFILE ROLLED MONOLITHIC SIDEWALK	
Date	Details	Approved		
			APPROVED: I.D.C.	STD. DWG. No.
			SCALE: N.T.S.	T8
			DATE: September, 2007	

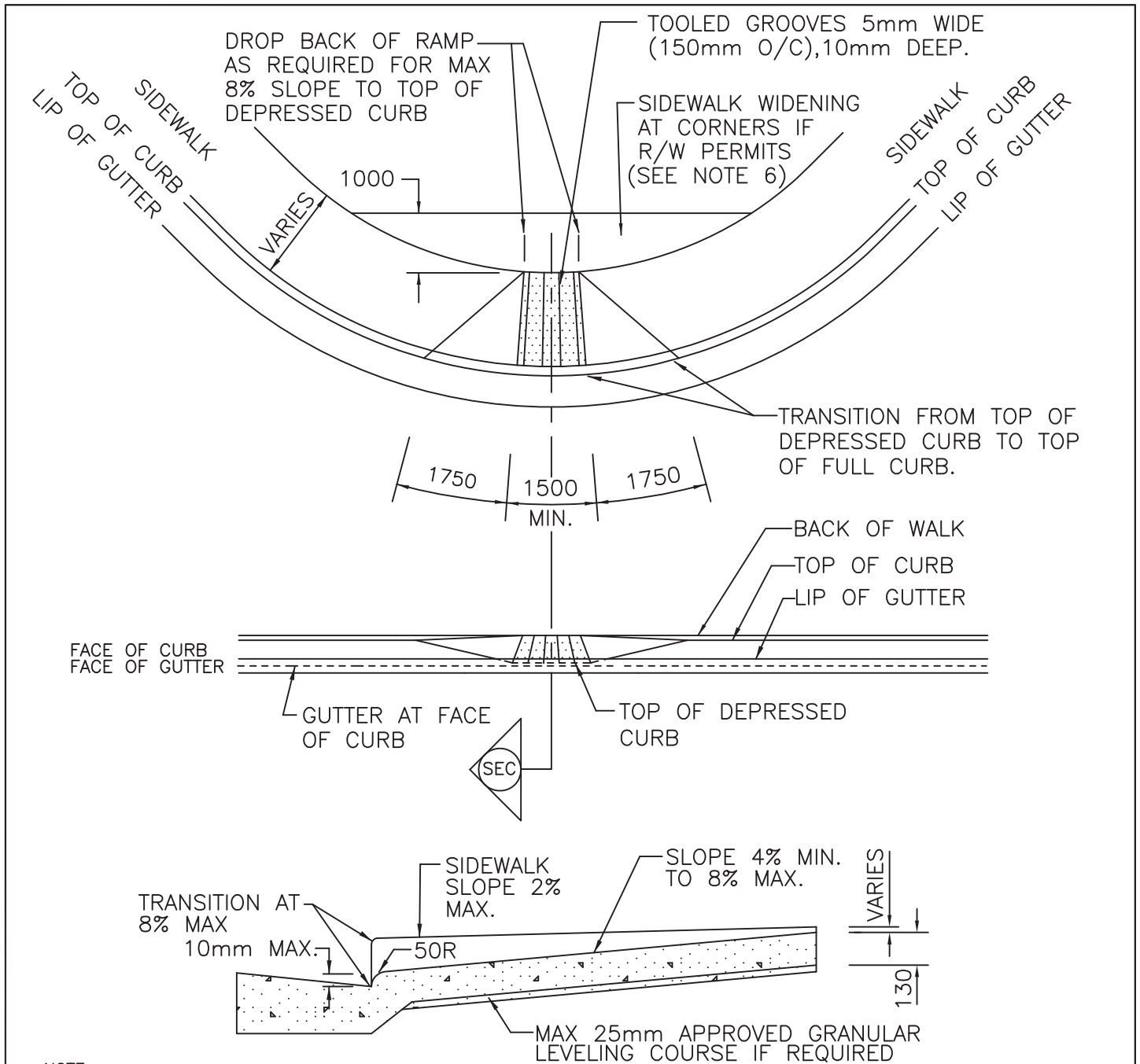

NOTE:

1. POUR CURB AND RAMP MONOLITHICALLY.
2. TRANSITION DISTANCE FROM TOP OF DEPRESSED CURB TO TOP OF FULL CURB VARIES WITH SIDEWALK DEPTH OR CURB HEIGHT.
3. RAMPS FOR USERS OF WHEELCHAIRS/BICYCLES SHOULD BE LOCATED AT ALL JUNCTIONS OF CROSSWALKS AND SIDEWALKS. RAMP MUST BE LOCATED WITHIN A CROSSWALK.
4. GROOVES ON SIDEWALK RAMPS ARE TO ALERT PERSONS WHO ARE VISUALLY IMPAIRED OF THE CURB-CUT AND A STREET CROSSING
5. WHERE CROSSWALKS ARE CONTROLLED BY SIGNALS WITH A PUSH-BUTTON SYSTEM, THE SIDEWALKS AND RAMPS MUST ALLOW ACCESS BY WHEELCHAIR TO THE PUSH-BUTTON
6. WHERE RIGHT-OF-WAY IS AVAILABLE, THE SIDEWALK IS TO BE WIDENED AT CORNER LOCATIONS AS SHOWN SO THAT AT LEAST A 1.0m WIDTH OF FLAT SIDEWALK IS PROVIDED ADJACENT TO THE RAMP.

REVISIONS			Town of Clareholm	
Date	Details	Approved		
			SIDEWALK RAMP	
			APPROVED: I.D.C.	STD. DWG. No.
			SCALE: N.T.S.	T9
			DATE: September, 2007	